

The MX Series Manual

Document part number: HB-MXXX-0001

Revision: **v3.0**

19-04-07



Caution: To reduce the risk of electric shock, do not remove any circuit board or power supply covers. There are no user serviceable parts inside; refer to qualified personnel.

Warning: To reduce the risk of fire or electric shock, do not expose this appliance to rain and moisture. The appliance should not be exposed to dripping or splashing and no objects filled with liquids should be placed on or near the appliance.

Detailed safety instructions

- 1 Read these instructions
- 2 Keep these instructions
- 3 Take notice of our warnings
- 4 Follow instructions
- 5 Clean only with a dry cloth
- 6 Keep the product away from liquids
- 7 Keep all ventilation openings free from obstructions
- 8 Install in accordance with these instructions
- 9 Do not install near significant sources of heat e.g. radiators, stoves etc.
- 10 Ensure the product is properly grounded
- 11 Only use attachments / accessories specified or approved by **Amulet Hotkey**
- 12 Refer all servicing to qualified personnel

About this manual.

This manual is designed to give you both an overview of the MX Series systems as well as a detailed explanation on how to install, configure and use it. However, there are bound to be questions we haven't answered so don't hesitate to contact technical support at Amulet Hotkey for expert assistance.

You can do this by phone or by email:

UK: +44 (0) 207 407 2522 or
+44 (0) 1626 854 600
US: +1 212 269 9300

European Tech Support:
eurosupport@amulethotkey.com

US Tech Support:
ussupport@amulethotkey.com

Asia Tech Support:
apsupport@amulethotkey.com

Check out the Tech. Support page of our website for additional contacts:

www.amulethotkey.com

Shipment.

1 Your MX Series components were carefully packed prior to despatch to guarantee safe transit. However, we recommend that you thoroughly examine all packaging and contents for signs of physical damage before use.

2 If any damage has occurred, please notify the shipping company and your supplier immediately otherwise claims for damage or replacement may not be granted.

3 Retain the original packaging for use in the event that the equipment has to be stored, shipped or returned for service.

4 If you choose to dispose of the packaging please do so in an environmentally friendly fashion. *We like our planet and want it to last a long time.* 😊

Conventions in this manual.

Throughout this manual we use notes in the page border to highlight points made in the main body of the text. These notes are marked with one of the following graphics:

Warning: Anything preceded by this icon is an important warning. You must read these and please take note of our advice.

Hints and Tips: Following this icon you will find what we consider to be useful advice based on our extensive experience. Take it or leave it – it's up to you.

Info: This icon signals information related to the main text that we thought we'd share with you. Hopefully you will find it of interest.



Introduction

Thank you from everyone here at Amulet Hotkey for purchasing the MX Series system. A great deal of time and energy has gone into making this the best and most reliable Digital extender system available.

With over 16 years experience working around the world in a variety of installations we are confident that we have provided a 'state of the art' system that will provide you with long and reliable service regardless of the application.

To get the best from this product please take time to study this manual carefully even if you are familiar with other Amulet Hotkey extenders.

Index		page
Section 1	Subject	4
1.1	Overview	4
Section 2		5
2.1	Front & Rear Panel Connections	5
2.2	Connection Diagram	6
2.3	Operation	7
Section 3		8
3.1	What's in the box	8
3.2	Troubleshooting	8
3.3	Technical Specifications	9
3.4	Technical Support	10



1.1 Overview

The Amulet Hotkey MX Series of media driver / splitters (also known as VGA and audio extender or video distribution system) provides a flexible solution for serving multiple monitors from a single SVGA video source.

The products are available in single, two and four channel versions, each of which is ideally suited to applications where information must be copied to a number of monitors using low cost twisted pair cable.

The MXR receiver unit is fitted with a drive compensation switch, which can be used to optimise the link for the best picture quality.

Up to 5 MX4s can be daisy-chained to give up to 20 channels of distribution.



It is recommended that the desktop unit is always connected to the power supply BEFORE the power is switched on.



Each link output on the mx 2/4 transmitter must be connected to an mxr receiver.



The mx Series transmitters and receivers are not compatible with other KVM extenders; including the Amulet Hotkey DX Series of products.

2

Installation & Operation

1. Referring to Figure 1, on page 6, connect the MX system together.
2. The MX power supplies can now be turned on. The 'Power' indicator on the MX will become illuminated.
3. The computer and monitors can now be turned on. The multi channel MX systems feature a 'LIVE' indicator. This will be illuminated if a video signal is present.
4. Rotate the drive compensation switches to achieve optimum video quality.

2.1 Front and Rear Panel Connections

Front Panel

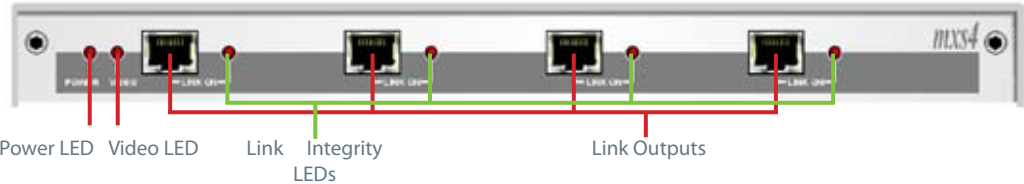

Rear Panel

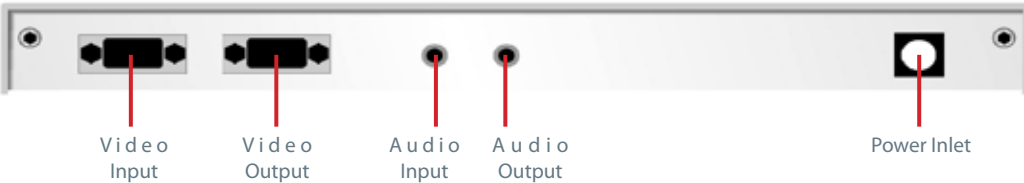

Maximum transmission distance without degradation will vary with cable quality.

2.2 Connection Diagram

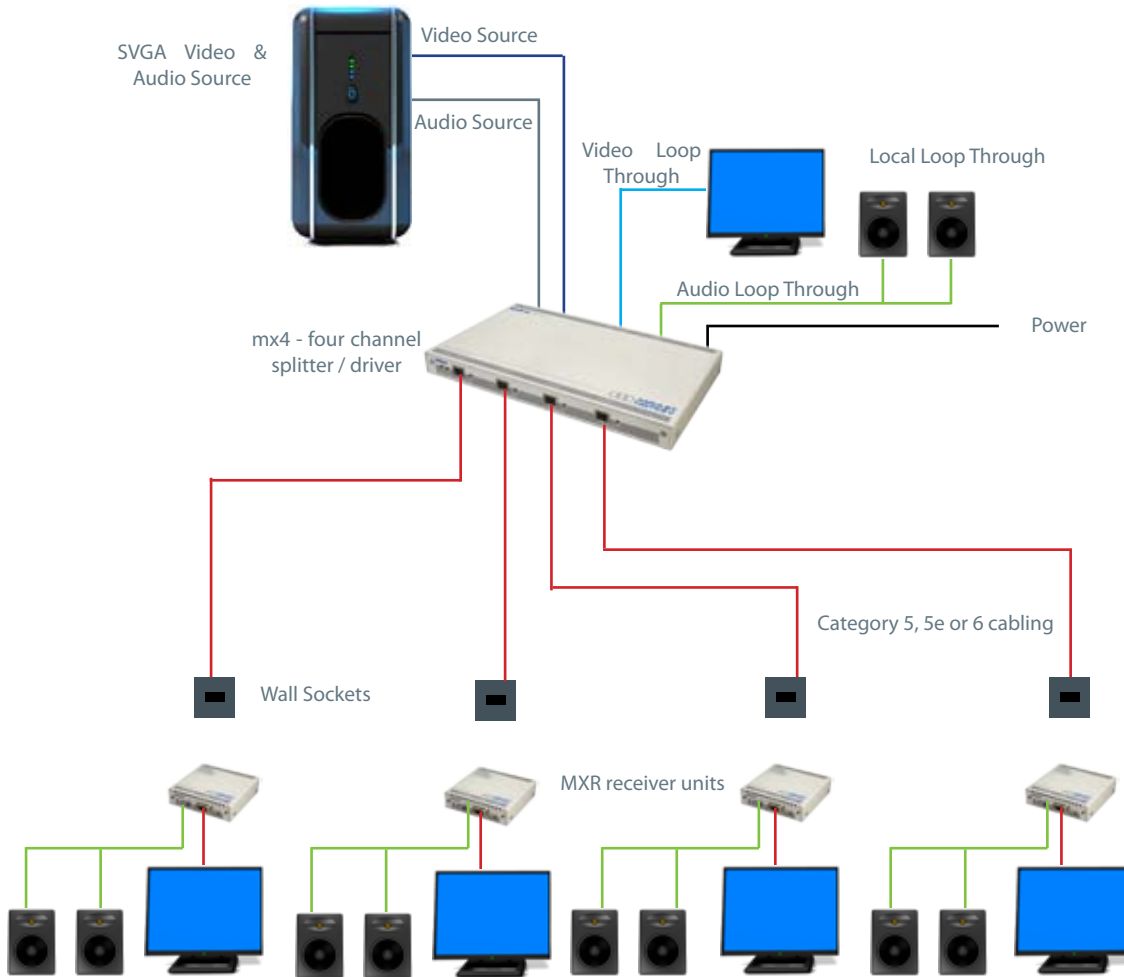

The example given here shows the four channel MX4 system. The single and two channel systems are much the same, except for the number of links.

2.3 Operation

The MX Series is capable of driving high quality SVGA video and audio up to 200 metres over standard Category 5, 5e and 6 twisted pair cable.

Each driver has a local loop-through allowing either the connection of a local monitor and speakers adjacent to the mx device, allowing easy maintenance. Alternatively, the local loop through can be used to cascade several mx units together, to drive up to 28 display stations.

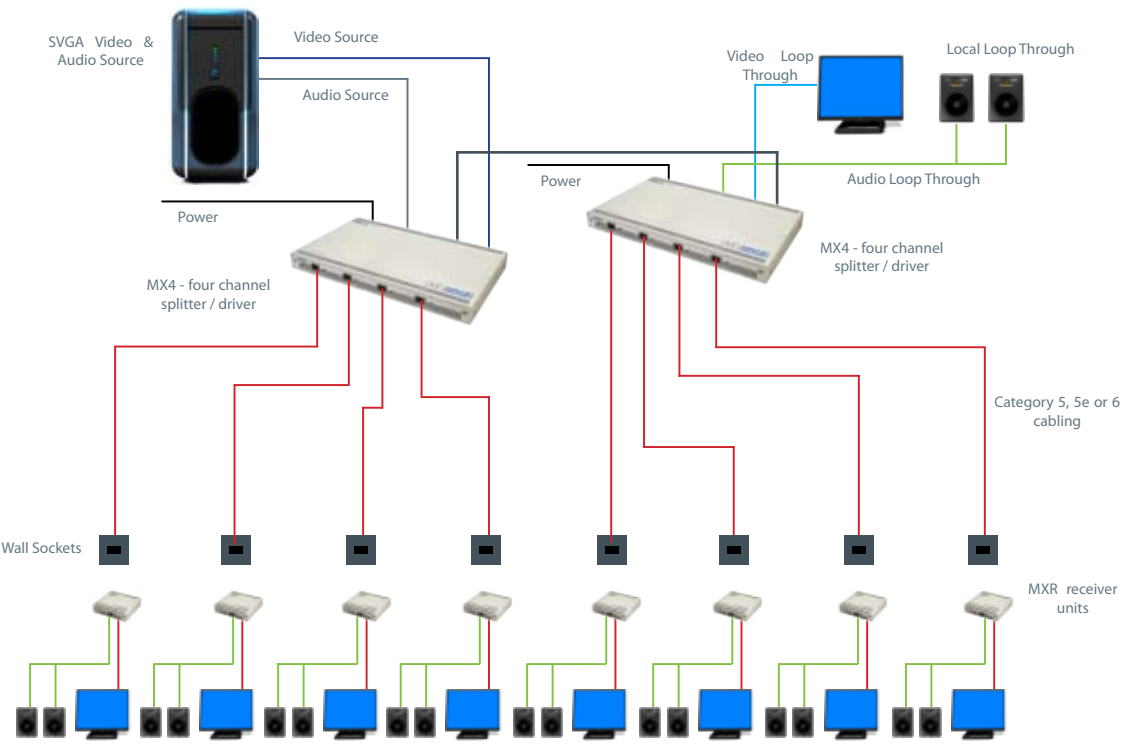

The example given here shows how the MX4 can be cascaded to support further channels.



3.1 What's in the Box (KT-MX01-0001)

1	CA-MXR1-0001	MXR Receiver with Skew Correction
1	CA-MXS1-0001	MX1 Driver complete assembly
1	CL-XX01-0008	HD15 to HD15 plug video cable (2m)
1	CL-XX01-0010	3.5mm plug to plug stereo audio lead 1.2m
2	CA-XX01-0002	12V, 1.25A Isolated ground PSU with IEC lead
1	HB-MXXX-0001	MXR hand book

Additional items needed

CAT 5, 5e or 6 cable is required for correct operation of the MX Series system. This cabling is user supplied and commonly found in preexisting network installations. If you are missing any of the listed items from your shipment, contact Amulet Hotkey Technical Support. You can find contact details on page 1 of this manual.

3.2 Troubleshooting

No Video

Check power to driver and receiver.

Make sure the computer is switched on.

Check Link Status. Red = Video Present, Green = Link Present, Orange = Both Present.

Cable test cabling between driver and receiver.

No Audio

Check and reseal audio connections to driver and receiver.

Make sure the units are powered.

Check the connection between the Host and the Driver.

Make sure audio isn't muted.

No Link

Check CAT5 cabling between driver and receiver

Make sure driver and receiver are both powered.

3.3 Technical Specifications

Dimensions	MX1	30 x 109 x 108mm
	MX2	30 x 286 x 175mm
	MX4	30 x 286 x 175mm
Power Supply	MX1	12VDC @ 250mA (isolated)
	MX2	12VDC @ 325mA
	MX4	12VDC @ 400mA
Video Input Socket		15way HDD
Video Input Impedence		75R
Video Resolution		1280 x 1024 @ 85Hz Max
Audio Input Socket		3.5mm Mini Jack
Audio Input Impedence		600Ohm nominal
Category 5 Drive Output		RJ45
Drive Compensation		8 levels @ 25m per level
Insertion Loss		0db
Signal Levels		1VPP
Transmission Distance		25 to 200 metres
Local Video Output		15 way HDD matched to 75R
Local Audio Output		3.5mm Mini jack line level
Complies With		CE, EN55022 & FCC part 15



3.4 Technical Support

UK: +44 (0)20 7407 2522
eurosupport@amulethotkey.com
Suites 27 - 29
The Hop Exchange
Southwark Street
London SE1 1TY

US: +1 212 269 9300
ussupport@amulethotkey.com
11 Hanover Square
19th Floor
New York, NY 10005
USA

Asia Pacific: apsupport@amulethotkey.com



www.amulethotkey.com